

Notices

Gouvernement du Québec

O.C. 24-2001, 17 January 2001

Ecological Reserves Act
(R.S.Q., c. R-26.1)

Réserve écologique de Mont-Saint-Pierre — Establishment

Establishment of Réserve écologique de Mont-Saint-Pierre

WHEREAS, under section 1 of the Ecological Reserves Act (R.S.Q., c. R-26.1), as amended by section 260 of chapter 40 of the Statutes of 1999, the Government may establish as an ecological reserve lands in the domain of the State where it considers it expedient for any of the following purposes:

- (1) to conserve the lands in their natural state;
- (2) to reserve the lands for scientific research and, where applicable, for education;
- (3) to protect threatened or vulnerable plant and animal species;

WHEREAS the Government is of the opinion that it is expedient to protect three populations, including the most important in Québec, of *Astragalus australis*, a threatened or vulnerable plant;

WHEREAS the project for establishing Réserve écologique de Mont-Saint-Pierre complies with the Programmation quinquennale de constitution des réserves écologiques 1996-2001 approved in July 1996;

WHEREAS the State owns the lands on which the proposed ecological reserve will be established;

WHEREAS none of the lands to be established as an ecological reserve are located in a reserved area or in an agricultural zone established under the Act respecting the preservation of agricultural land and agricultural activities (R.S.Q., c. P-41.1);

WHEREAS Municipalité régionale de comté de Denis-Riverin (now named “Municipalité régionale de comté de La Haute-Gaspésie”) confirmed that the project complies with its development plan;

WHEREAS the Commission de toponymie du Québec gave a favourable opinion on the use of the name “Réserve écologique de Mont-Saint-Pierre”;

WHEREAS in accordance with section 2 of the Ecological Reserves Act, amended by section 158 of Chapter 36 of the Statutes of 1999, a notice briefly describing the proposed establishment of Réserve écologique de Mont-Saint-Pierre was published on 23 February 2000 in the *Gazette officielle du Québec* and on 2 April 2000 in the local newspapers *Le Riverain* and *The Spec* and no unfavourable point of view was communicated to the Minister of the Environment following those publications;

WHEREAS under section 3 of the Ecological Reserves Act, any order made pursuant to sections 1 and 2 comes into force on the date of its publication in the *Gazette officielle du Québec* or on any later date fixed therein;

IT IS ORDERED, therefore, on the recommendation of the Minister of the Environment:

THAT the territory whose plan and technical description are attached to this Order in Council be established as an ecological reserve under the name “Réserve écologique de Mont-Saint-Pierre”;

THAT this Order in Council come into force on the date of its publication in the *Gazette officielle du Québec*.

MICHEL NOËL DE TILLY,
Clerk of the Conseil exécutif

CANADA
PROVINCE OF QUÉBEC
SAINT-ANNE-DES MONTS LAND DIVISION

TECHNICAL DESCRIPTION

RÉSERVE ÉCOLOGIQUE DE MONT-SAINT-PIERRE

A territory made up of a piece of land of irregular shape, formed by lots 84, 85, 86, 87, 88, 89, 90, 91-1, 92-1, 93-1, 94-1, 95-4, 96-2, 97-3 and 98-4 and part of lots 76, 77, 78, 79, 80, 81, 82, 83, 95-1, 95-2, 95-3, 96-1, 99-4 and 117 of the revised cadastre of Municipalité de Saint-Maxime-du-Mont-Louis, on the territory of Municipalité régionale de comté de Denis-Riverin, in the Gaspésie-Îles-de-la-Madeleine administrative region.

The perimeter of that territory whose geographic focus is approximately located at 49° 11' 00" latitude NORTH and at 65° 48' 00" longitude WEST may be explicitly described as follows, namely:

Starting from point A on the dividing line between lots 99-4 and 100-2 at the intersection of that line with lot 99-3, the approximate SCOPQ coordinates of the said point A being 5 542 562 metres NORTH and 209 983 metres EAST;

Thence, following the dividing line between lots 99-4 and 100-2 over a distance of 173 metres, up to point B;

Thence, following a sinuous line forming the southern limit of a road excluded from the ecological reserve, in a general easterly direction, over a distance of 640 metres, up to point C;

Thence, following the dividing line between lots 99-4 and 117 over a distance of 198 metres, up to point D;

Thence, following the dividing line between lots 98-4 and 97-3 and lot 117 over a distance of 354 metres, up to point E;

Thence, following a sinuous line in a general south-easterly direction along the eastern limit of an old forest road included in the ecological reserve, over a distance of 1047 metres up to point F; the approximate SCOPQ coordinates of the said point F being 5 451 547 metres NORTH and 211 160 metres East;

Thence, following a straight line on a bearing of 118° 00' 00" over a distance of 271 metres, up to point G;

Thence, following a straight line on a bearing of 176° 00' 00" over a distance of 96 metres, up to point H;

Thence, following a straight line on a bearing of 138° 00' 00" over a distance of 96 metres, up to point J;

Thence, following a straight line on a bearing of 249° 00' 00" over a distance of 223 metres, up to point K;

Thence, following a sinuous line in a general south-easterly direction along the eastern limit of an old forest road included in the ecological reserve, over a distance of 1374 metres up to point L, the approximate SCOPQ coordinates of the said point L being 5 450 036 metres NORTH and 211 639 metres EAST;

Thence, following a sinuous line in a general south-westerly direction along the northern and western limits of a road leading to the ski resort excluded from the ecological reserve, over a distance of 2215 metres to

point M, the approximate SCOPQ approximate coordinates of the said point being 5 448 596 metres NORTH and 211 236 metres EAST;

Thence, following a sinuous line in a general westerly direction along the western and southern limits of a stream included in the ecological reserve, over a distance of 1504 metres up to point N, the approximate SCOPQ coordinates of the said point N being 5 448 504 metres NORTH and 209 980 metres EAST;

Thence, following a sinuous line in a general northerly direction along the eastern limit of a road leading to the ski resort excluded from the ecological reserve over a distance of 409 metres, up to point P;

Thence, following the natural high water mark of Rivière de Mont-Saint-Pierre, in a general northerly direction on the eastern side over a distance of 2495 metres, up to point Q;

Thence, following the sinuous line dividing lots 91-1 and 91-2, 92-1 and 92-2, 93-1 and 93-2 and 94-1 and 94-2, in a general northerly direction, over a distance of 784 metres, up to point R;

Thence, following the dividing line between lots 94-2 and 95-1 up to point S, which is 242.50 metres from the intersection of the dividing line between lots 94-2 and 95-1 with the eastern bank of Rivière de Mont-Saint-Pierre, that distance being measured on the dividing line between the said lots;

Thence, following a sinuous line in a general northerly direction, over a distance of 252.95 metres up to point T, which is 249.92 metres from the intersection of the dividing line between lots 95-3 and 96-1 with the eastern bank of Rivière de Mont-Saint-Pierre, that distance being measured on the dividing line between the said lots;

Thence, following the dividing line between lots 96-1 and 95-3 over a distance of 72.19 metres, up to point U;

Thence, following a sinuous line in a general north-easterly direction, over a distance of 240.26 metres up to point V, which is 439.05 metres from the intersection of the dividing line between lots 96-1 and 97-1 with the eastern bank of Rivière de Mont-Saint-Pierre, that distance being measured on the dividing line between the said lots;

Thence, following the dividing line between lots 97-1 and 96-1 up to point W, located at the intersection of the said dividing line with lot 97-3;

Thence, following to the north the sinuous line that separates lots 97-1 and 97-2 from lot 97-3, lots 98-1, 98-2 and 98-3 from lot 98-4, lots 99-1, 99-2 and 99-3 from lot 99-4, over a total distance of 639 metres up to point A, the starting point.

The approximate area of the above-described territory is 643 hectares and it is shown on the plan attached hereto at a scale of 1 : 20 000, drawn up on an excerpt from the topographic map made in 1983 by the Ministère des Ressources naturelles du Québec, leaf 22H 04-200-0201.

Note: The coordinates given in this description were graphically traced on leaf 22H 04-200-0201 of the above-mentioned map, in reference to the official plane coordinate system of Québec (SCOPQ, modified transverse Mercator projection system, Zone 5, central meridian 64° 30' 00" West, North American datum 1983).

Note: The survey of those territorial boundaries will determine the perimeter of the ecological reserve.

Note: The distances given in the "S-T", "T-U" and "U-V" segments refer to the technical description prepared by Mr. Jean-Paul Lavoie, l.s. under Minute 5504 dated 9 March 1998.

The whole as shown on the plan prepared by Claude Vincent, land surveyor, bearing minute number 3143.

Given at Québec, on the fourth day of May 2000.

CLAUDE VINCENT,
Land surveyor

Y/R: 5141-03-11 [1.24]
O/R: 00/024
Minute No. 3143

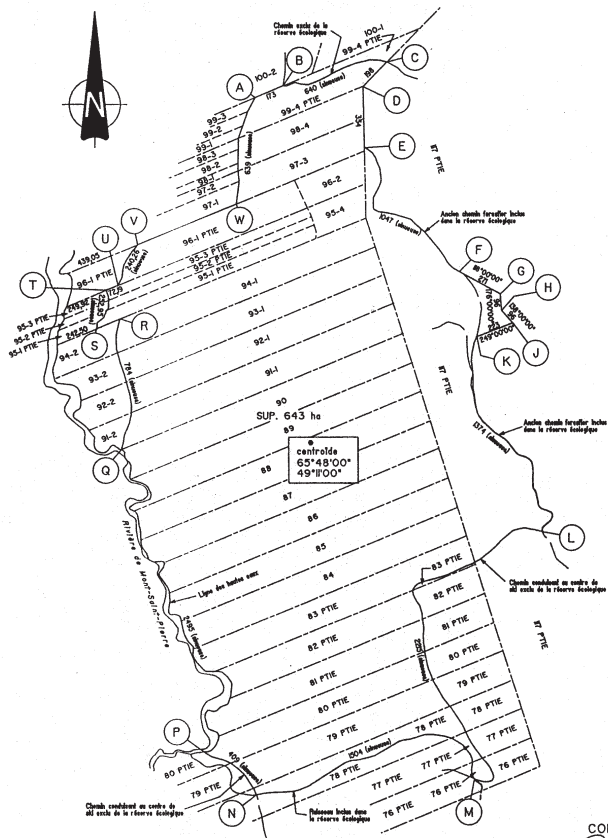

COPIE CONFORME
Claude Vincent
 5 mai 2000

PLAN ACCOMPAGNANT LA DESCRIPTION TECHNIQUE
 DE LA RÉSERVE ÉCOLOGIQUE DE MONT-SAINT-PIERRE
 MINISTÈRE DE L'ENVIRONNEMENT DU QUÉBEC
 DIRECTION DU PATRIMOINE ÉCOLOGIQUE ET
 DU DÉVELOPPEMENT DURABLE
 DOSSIER: 5141-03-II [1.24]

Lots: 84, 85, 86, 87, 88, 89, 90, 91-1, 92-1, 93-1, 94-1, 95-4, 96-2 97-3
 et 98-4 et d'une partie des lots 76, 77, 78, 79, 80, 81, 82, 83, 95-1, 95-2,
 95-3, 96-1, 99-4 et 117

Cadastre révisé de la municipalité de Saint-Maxime-du-Mont-Louis
 Municipalité régionale de comté de Denis-Riverin
 Circonscription foncière: Sainte-Anne-des-Monts
 Circonscription électorale de Gaspé
 Région Administrative: Gaspésie-Iles-de-la-Madeleine

QUÉBEC, le 4 mai 2000
 préparé par: *Claude Vincent*
 CLAUDE VINCENT
 arpenteur-géomètre

N.B. Les directions apparaissent sur ce document
 soit des géomètres en référence au
 système SCOT'0 (fuseau 5) NAD 83
 N.B. Les mesures indiquées sur ce document sont
 en mètres (SI).

ÉCHELLE: 1 : 20 000

CLAUDE VINCENT
 ARPENTEUR-GÉOMÈTRE
 2405, rue De Cellas, bureau 4A, Québec, (Québec) G2C 4K7
 Tél.: (418) 840-1588, Fax: (418) 840-1788

MINUTE: 3143
 DOSSIER: 00-024
 FICHER: 00024.des